

# Wiring Harness Accessories for PV100 PowerView Module and PVA Analog Gages

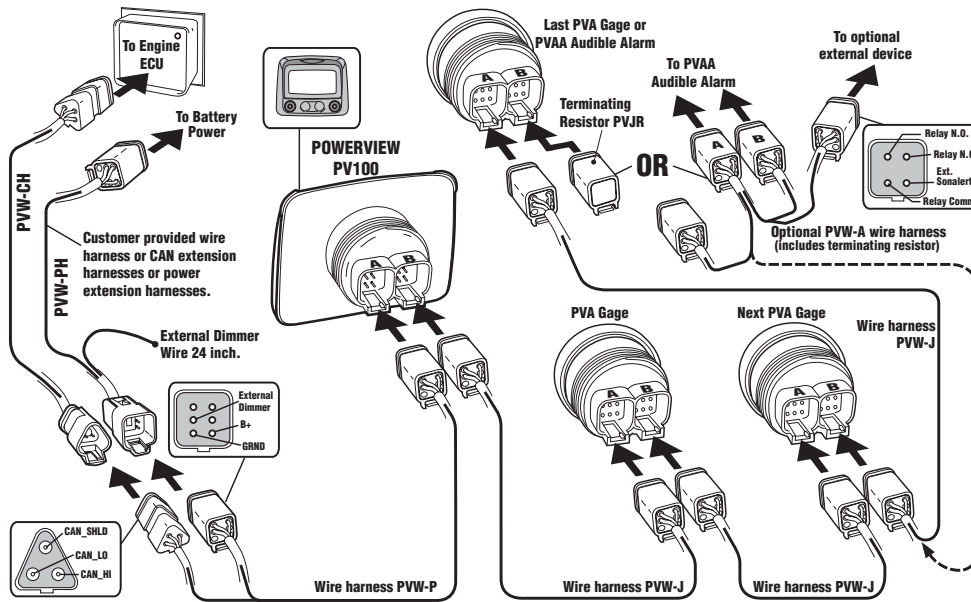

Use the Easy Connect Diagram (shown below) to help you locate the wiring harness you need. The charts (below the diagram) include the harness

accessories' part number, a brief description of the item and a designation schematic to help you with selection of wiring leads length (if applicable).



Model	Wiring Harness Rendering	Wiring Harness Designation Schematic	Part Number
<b>PVW-P-12</b> CAN and Power Harness for PowerView Module	 Length: 12 in. (305 mm.)	PVW-P-12 CAN and Power Harness (includes 120Ω CAN resistor)	78000124
Model	Wiring Harness Rendering	Wiring Harness Designation Schematic	Part Number
<b>PVW-J</b> PowerView Jumper Harness		PVW-J-9 Audible Alarm Jumper Harness Length: - 9 : 9 in. (229 mm.) - 12 : 12 in. (305 mm.) - 24 : 24 in. (607 mm.)	78000121 78000122 78000123
Model	Wiring Harness Rendering	Wiring Harness Designation	Part Number
<b>PVW-A-12</b> PowerView Audible Alarm Jumper Harness: Provides alarm relay contacts for external devices.	 3 Relay Contacts PVAA Gage	PVW-A-9 Jumper Harness Includes terminating Length: - 9 : 9 in. (229 mm.) - 12 : 12 in. (305 mm.) - 24 : 24 in. (607 mm.)	78000153 78000154 78000155
Model	Terminating Resistor Rendering	Resistor Designation	Part Number
<b>PVJR</b> Terminating Resistor		PVJR Use on last PVA Gage — not needed for PV100	78000128



### Wiring Harness Accessories for PV100 PowerView Module and PVA Analog Gages

Model	Wiring Harness Rendering	Wiring Harness Designation Schematic	Part Number
<b>PVW-CH</b> PowerView CAN Extension Harness		PVW-CH-72 <b>PowerView CAN Extension Harness</b> <b>Length:</b> - 72 : 72 in. (1.82 m) - 144 : 144 in. (3.65 m) - 240 : 240 in. (6.10 m) - 360 : 360 in. (9.10 m)	78000157 78000158 78000159 78000160
<b>PVW-PH</b> PowerView Battery Power Extension Harness		PVW-PH-72 <b>PowerView Battery Power Extension Harness</b> <b>Length:</b> - 72 : 72 in. (1.82 m) - 144 : 144 in. (3.65 m) - 240 : 240 in. (6.10 m) - 360 : 360 in. (9.10 m)	78000149 78000150 78000151 78000152
<b>PVW-K</b> PowerView Wiring Kit Includes: (1) PVW-P (4) PVW-J (1) PVJR	 (1) PVW-P (4) PVW-J (1) PVJR	PVW-K-12 <b>Length:</b> - 12 : 12 in. (305 mm.) - 24 : 24 in. (607 mm.)	78000188 78000189
<b>PVW-PW-30</b>	<b>PowerView CAN Loose Wiring</b> Length: 30 in. (762 mm.) 	<b>Wiring Harness Designation</b> PVW-PW-30	<b>Part Number</b> 78000125
<b>PVW-CC-24</b>	<b>PowerView CAN Loose Wiring</b> Length: 24 in. (607 mm.) 	<b>Wiring Harness Designation</b> PVW-CC-24	<b>Part Number</b> 78000127
<b>PVW-PC-24</b>	<b>PowerView Power Loose Wiring</b> Length: 24 in. (607 mm.) 	<b>Wiring Harness Designation</b> PVW-PC-24	<b>Part Number</b> 78000126
<b>PVW-CT</b>	<b>CAN BUS Tee Wiring Harness</b> 	<b>Wiring Harness Designation</b> PVW-CT	<b>Part Number</b> 00009510

5